

DIMENSIONS & DATA CERTIFIED FOR:

Representative:

Order:

Customer:

Order:

Project:

Requirements:

By:

Date:

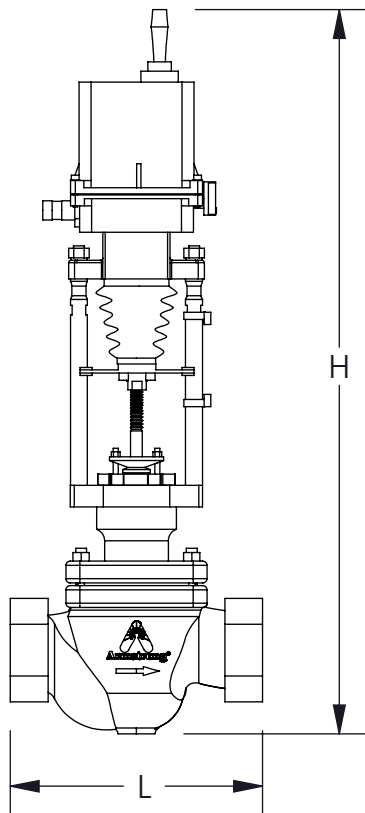
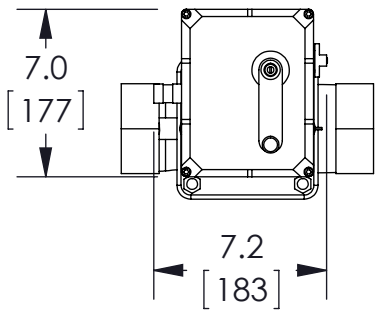

LIST OF MATERIALS

NAME OF PART	MATERIAL
BODY, VALVE*, BONNET*	A216 GR. WCB CARBON STEEL
VALVE & VALVE SEAT	AISI 431 STAINLESS STEEL
VALVE STEM	T316 STAINLESS STEEL
GLAND PACKING	V-TFLON OPT. 1(366°F [186°C] MAX), GRAPHOIL OPT.2
YOKE	S.G. IRON
BODY, ACTUATOR	DIE CAST ALUMINUM
BOOT BELLOWS, ACTUATOR	EPDM
* STAINLESS STEEL OPTION	

TECHNICAL INFORMATION

MODEL NO.	PYTHON 1100 SERIES CONTROL VALVE	
PLUG DESIGN	CONTOURED TOP GUIDED (UNBALANCED)	
FLOW CHARACTERISTICS	PLUG AND SEAT	
LEAKAGE	ANSI CLASS IV	
TRAVEL IN[MM]	1-1/8[28]	
MAX. ALLOWABLE PRESSURE (VESSEL DESIGN)	300 PSI @ 450°F [20 BAR @ 232°C]	
MODEL NO.	AEL1438	
SWITCHING THRUST(N)	1-1/4"	3600
	1-1/2"	4600
	2"	7200
CONTROL SIGNAL	4-20 mA MODULATING	
CONTROL VOLTAGE	24 VOLTS AC (120V AC OR 240V OPT.)	
SPEED (MM/MIN)	48	

DESIGN INFORMATION

SIZE NPT[DN]	"L" IN[MM]	"H" IN[MM]	CV	WEIGHT LBS. [KGS]
1-1/4[32]	9.3[235]	26.1[664]	20	39[18]
1-1/2[40]			30	
2[50]	10.5[267]	26.7[678]	50	48[22]

Dimensions Are In Inches [mm]



Product

CV AEL 1-1/4 1-1/2 2 NPT CCS WCB
TG TEFL 4-20 24VAC

ENGLISH

WEB
Y|N

CD No.

CD2826

Rev;

A

Date

01/11/2013

SHEET 1 OF 1

By: GANESH KUMAR