

DIMENSIONS & DATA CERTIFIED FOR:

Representative:

Order:

Customer:

Order:

Project:

Requirements:

By:

Date:

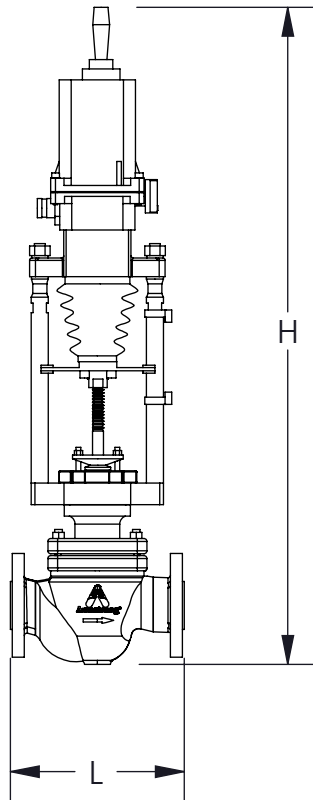
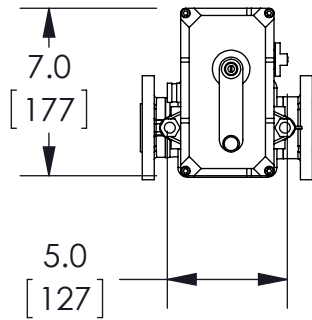

LIST OF MATERIALS

NAME OF PART	MATERIAL
BODY, VALVE*, BONNET*	A216 GR. WCB CARBON STEEL
VALVE & VALVE SEAT	AISI 431 STAINLESS STEEL
VALVE STEM	T316 STAINLESS STEEL
GLAND PACKING	V-TFLON OPT. 1(366°F [186°C] MAX), GRAPHOIL OPT.2
YOKE	S.G. IRON
BODY, ACTUATOR	DIE CAST ALUMINUM
BOOT BELLOWS, ACTUATOR	EPDM
* STAINLESS STEEL OPTION	

TECHNICAL INFORMATION

MODEL NO.	PYTHON 1100 SERIES CONTROL VALVE
PLUG DESIGN	CONTOURED TOP GUIDED (UNBALANCED)
FLOW CHARACTERISTICS	PLUG AND SEAT
LEAKAGE	ANSI CLASS IV
TRAVEL IN[MM]	11/16[18]
MAX. ALLOWABLE PRESSURE (VESSEL DESIGN)	300 PSI @ 450°F [20 BAR @ 232°C]
MODEL NO.	AEL1430
SWITCHING THRUST(N)	1900
CONTROL SIGNAL	4-20 mA MODULATING
CONTROL VOLTAGE	24 VOLTS AC (120V AC OR 240V OPT.)
SPEED (MM/MIN)	28

DESIGN INFORMATION

SIZE IN[DN]	"L" IN[MM]	"H" IN[MM]	CV	WEIGHT LBS. [KGS]
1/2 [15]	7[178]	14.6[370]	5	34[15]
3/4[20]	7.1[181]		9	
1[25]	7.3[184]	24.9[633]	13	36[16]

Dimensions Are In Inches [mm]



Product

CV AEL 1/2 3/4 1 150RF CCS WCB
TG TEFL 4-20 24VAC

ENGLISH

WEB
Y|N

CD No.

CD2827

Rev;

A

Date

02/26/2013

SHEET 1 OF 1

By: GANESH KUMAR