

DIMENSIONS & DATA CERTIFIED FOR:

Representative:

Order:

Customer:

Order:

Project:

Requirements:

By:

Date:

Dimensions & Weights							
SIZE	Flange Class	L	A	H Integral	H1	Weight	Cv [Kv]
2" [50]	150	8-9/16" [218mm]	10-15/16" [276mm]	19-5/8" [498mm]	8-1/2" [216mm]	88 lbs. [40 kgs]	32 [28]
	300	9-1/16" [231mm]				82.5 lbs. [42 kgs]	
2-1/2" [65]	150	10-15/16" [277mm]	13-13/16" [352mm]	21-3/4" [552mm]	9-7/8" [251mm]	159 lbs. [72 kgs]	60 [52]
	300	11-1/2" [293mm]				150 lbs. [68 kgs]	
3" [80]	150	11-11/16" [297mm]	13-13/16" [352mm]	22-5/8" [575mm]	10-3/8" [264mm]	174 lbs. [79 kgs]	78 [67]
	300	12-7/16" [316mm]				166 lbs. [75 kgs]	
4" [100]	150	13-7/16" [342mm]	15-3/4" [401mm]	25-7/8" [658mm]	12-5/8" [321mm]	274 lbs. [124.5 kgs]	120 [104]
	300	14-1/16" [358mm]				264 lbs. [120 kgs]	

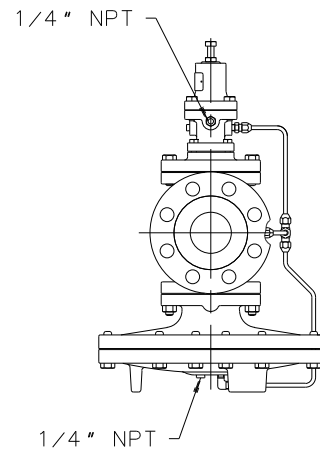

Specifications					
Application	Inlet Pressure	Reduced Pressure	Spring Color Code	Maximum Temperature	Minimum Differential
STEAM	CL. 150 FLG. 15-139 psig 600F [1-9.6 bar 315C]	3-21 psig [.2-1.4 bar]	YELLOW	600 °F [315 °C]	7.5 psig [.51 bar]
		15-200 psig 390F [1-13.7 bar 198C]	GREEN		
	CL. 300 FLG. 15-450 psig [1-31 bar]	3-21 psig [.2-1.4 bar]	YELLOW		
		15-200 psig [1-13.6 bar]	GREEN		
		190-300 psig [13.1-20.6 bar]	BROWN		

List Of Materials	
Body	WCB ASTM A216 / A216M-08
Main Valve/Seat	Stainless Steel AISI 304 Stellite#6
Pilot Valve/Seat	Stainless Steel AISI 420
Diaphragm	Stainless Steel AISI 301
Gasket	Non-Asbestos

INTEGRAL MOUNT

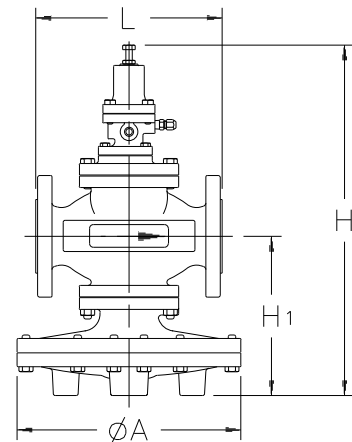

Armstrong Pressure/Temperature Group
 221 Armstrong Blvd.,
 Three Rivers, MI. 49093
Armstrong (269) 279-3600 Fax(269) 273-8656
 Posted on www.armstronginternational.com

Product	CDY No.	Date
GP-2000CS FLANGED	CD2448	03/22/10
		Rev. A