

DIMENSIONS & DATA CERTIFIED FOR:

Representative:

Order:

Customer:

Order:

Project:

Requirements:

By:

Date:

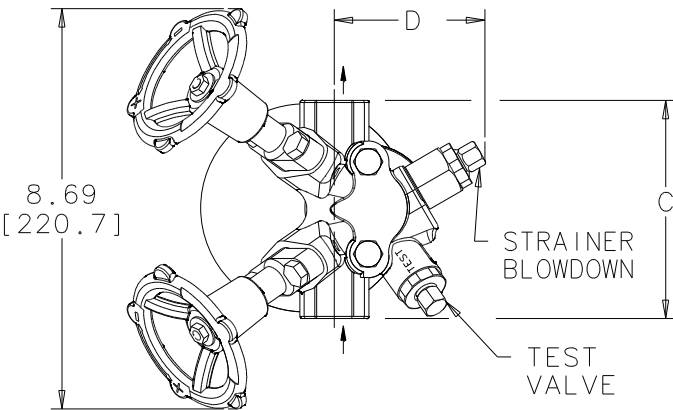
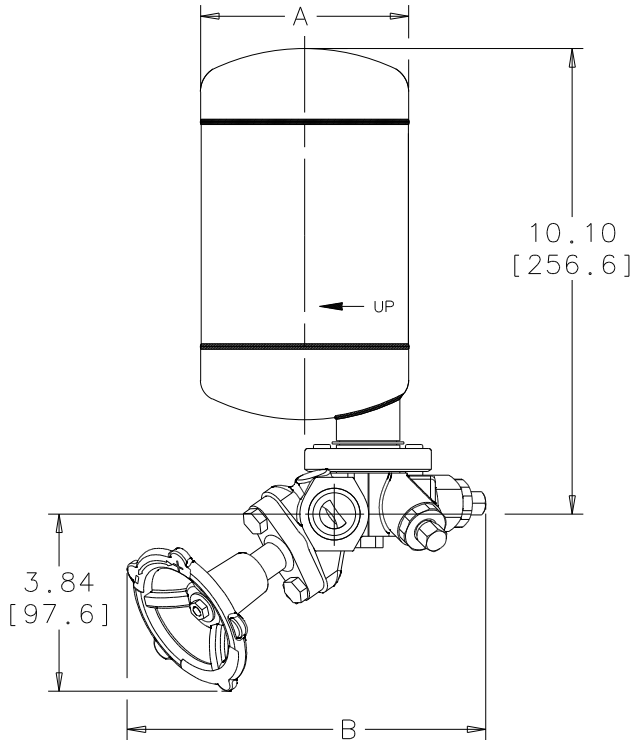

3/4 NPT Left-To-Right Shown

Dimensions Are In Inches[mm]

LIST OF MATERIALS:

NAME OF PART	MATERIAL
CAP & BODY	ASTM A240 T304L
SEAT, VALVE	ASTM A582 T303
VALVE	ASTM A564 17-4 PH H900
VALVE RETAINER & LEVER	ASTM A240 T304
GUIDE PIN ASS'Y	
FLOAT	
CAPSULE & ADAPTER	ASTM A582 T303
HANDWHEEL	DUCTILE IRON A536 GR. 60
BODY & BONNET	ASTM A351 GR. CF8M
BOLTS	DIN 933 GR. A2 S.S.
VALVE PLUGS	ASTM A564 17-4 H900 S.S.
LANTERN BUSHINGS	ASTM A582 T304
VALVE RINGS	GRAPHITE & S.S.
VALVE WASHER	ASTM A582 T304
DISC SPRINGS	AISI T301
NUT/FLAT WASHERS	AISI T304
SCREEN	ASTM A167 T304 20x20 MESH
GASKET, RETAINER	ASTM A167 T316
STRAINER BLOWDOWN & TEST VALVE ASS'Y	ASTM A582 T303
FLANGE	ASTM A105, ZINK PLATED
RETAINER RING	CARBON STEEL
FLANGE RETAINER	T304L
CONNECTOR GASKET	T304L S.S. NON-ASBESTOS

TECHNICAL INFORMATION

MODEL NO.	TVS4000
CONNECTION	1/2[DN15] Or 3/4[DN20]
"A" (Ø BODY)	4-1/2 [114.3]
"B" (HEIGHT)	7-7/8 [200]
"C" (FACE TO FACE)	4-3/4 [120.7]
"D" (Ø TO BLOWDOWN)	3-1/4 [82.6]
WEIGHT (lbs)	13 [6 kgs]

OPTIONS:

CONNECTION	NPT	
	BSPT	
	SW	
INLET ORIENTATION	RIGHT-TO-LEFT	
	LEFT-TO-RIGHT	

DESIGN INFORMATION

PMA (VESSEL DESIGN)	485 psig @ 600°F * [33.4 bar @ 315°C]
ΔPMx (MAX. OPERATING psi)	465 psi Sat. Steam * [32 bar]



Product ENGLISH
FT4000 W/ TVS4000 CONNECTOR
TRAP ASSY

WEB
Y
N
✓

CD No.
1299

Date
3/26/08

Rev; A

By; paulg