

# DIMENSIONS & DATA CERTIFIED FOR:

Representative:

Order:

Customer:

Order:

Project:

Requirements:

By:

Date:

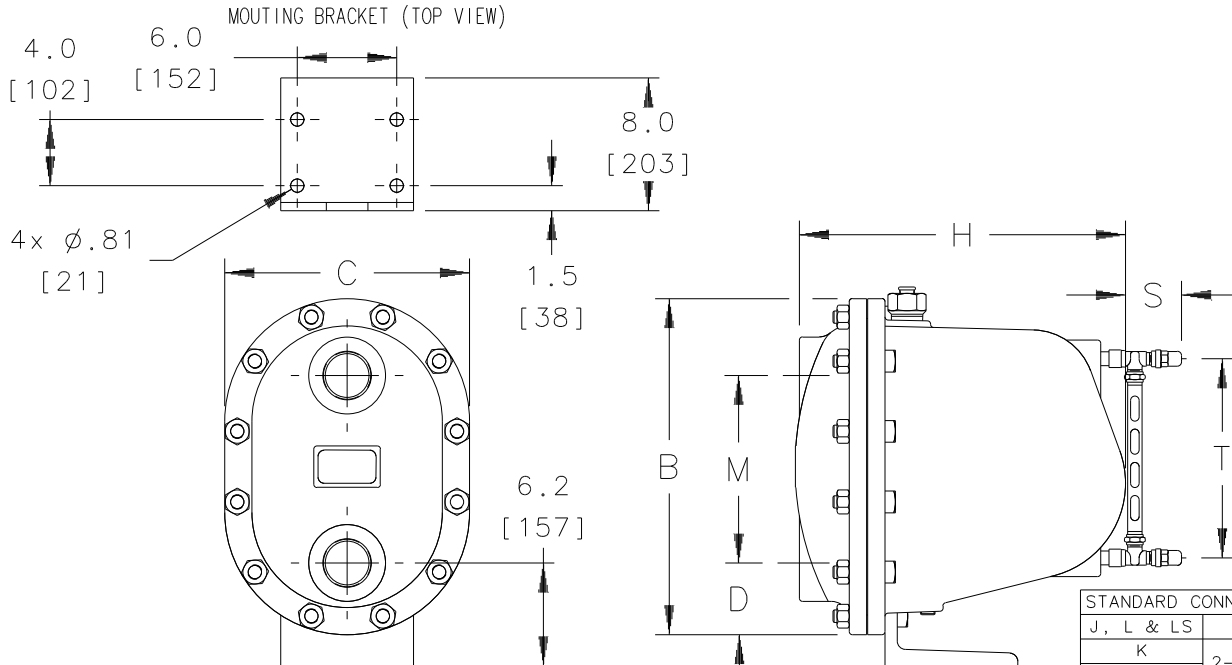

## LIST OF MATERIALS

NAME OF PART	MODEL	MATERIAL
Cap and Body	J, K, L & M	ASTM A48 Class 30
	LS & MS	ASTM A216 Grade WCB
Cap Extension*	L & LS	ASTM A351 Grade CF8 & T304 SS
	M & MS	ASTM A747 Grade CB7Cu-1, 17-4 PH
Cap Bolting	L, LS, M & MS	ASTM A193 Grade B7
	J & K	ASTM A307 Grade B
Cap Gaskets		Compressed Non-asbestos
Valve		ASTM A582 T440C
Valve Seat		Hardened Stainless Steel
Float	J, K, L, M, LS & MS	ASTM A167 T304 SS
Mechanism		ASTM A276 T304 SS
Balanced Pressure Thermostatic Air Vent		ASTM A167 T304 SS Shell & Bronze/ Phosphor Bellows

\* 'J' Series does not have cap extension.

DESCRIPTION	TRAP SERIES			
	J	K	L & M	LS & MS
*B* (Height)	13-1/6[332]		20-1/4[514]	20[508]
*C* (Width)	9-11/16[246]		14-3/4[375]	15-1/4[387]
*D* (Bottom to C)	2-15/16[75]		4-3/16[106]	
*H* (Length)	13-11/16[348]	14-11/16[373]	19-3/4[502]	20[508]
*M* (C to C)	6-5/8[168]		11-5/16[287]	
*P* (Trap top to VB top)	1-13/16[46]		-	-
*S* (Gage Glass Width)	-	-	3-3/4[95]	
*T* (Gage Glass Height)	-	-	12[305]	
Weight (lbs)	80[36kgs]	87[40kgs]	196[89kgs]	290[132kgs]
Maximum Allowable Pressure (Vessel Design)	175 psig [12 bar] at 450°F [232°C]		250 psig [17 bar] at 450°F [232°C]	450 psig [31 bar] at 650°F [343°C]

Note: Dimensions are in Inches[mm]

### OPTIONS:

- "L", "LS", "M" & "MS" Series available with armored gauge glass which must be specified on original order. Maximum allowable pressure, 250 psig at 425°F.
- All Armstrong F&T traps are available with integral vacuum breakers for service pressures up to 150 psi. Suffix "VB" to model number.
- "L" & "LS" Series traps are available with 2" connections. Specify 30-L8, 30-LS8, 100-L8, 100-LS8, etc.
- "L", "LS", "M", & "MS" Series available with flanges. Consult factory.
- "L", "LS", "M" & "MS" Series available with floor mounting bracket. Consult factory.



Armstrong International, Inc.  
Three Rivers Division  
Three Rivers, MI 49093

**Armstrong** (269) 273-1415 Fax(269) 278-6555  
Posted on Armstrong's homepage [www.armstrong-intl.com](http://www.armstrong-intl.com)

Product	CD No.	Date
DRAIN TRAP J, K, L, M, LS & MS SERIES	1010	6/24/03
		Rev. D