

# DIMENSIONS & DATA CERTIFIED FOR:

Representative:

Order:

Customer:

Order:

Project:

Requirements:

By:

Date:

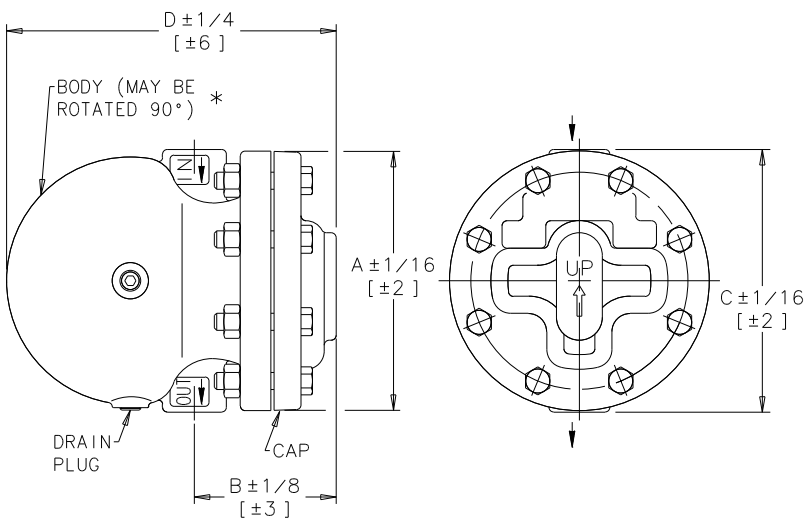

MODEL CST  
TOP INLET ORIENTATION  
1/2 & 3/4 CONN. SHOWN ABOVE

DIMENSIONS ARE IN INCHES[mm]

Socket Weld Conn.  
ANSI B16.11

## LIST OF MATERIALS:

NAME OF PART	MATERIAL
CAP & BODY	ASTM A216 WCB
GASKET, BODY	GRAPHITE BONDED
BOLT (8)	ASTM A193 GR. B7
NUT (8)	ASTM A194 GR. 2H
SEAT, VALVE	ASTM A582 T303
VALVE	ASTM A582 T440F/ASTM A564 T630
RETAINER, VALVE	ASTM A167 T302
PIVOT PIN	ASTM A580 T304
FLOAT	
LEVER ASS'Y	ASTM A167 T304
WT ASS'Y	T304 S.S.
GASKET, WT	18-8 S.S.
NAME PLATE	ALUMINUM
PLUG, DRAIN NPT(3)	CARBON STEEL

## TECHNICAL INFORMATION

MODEL NO.	*BODY ORIENTATION (Top) (Left) (Right) CST CSL CSR
CONNECTIONS:	1/2[DN15] Or 3/4[DN20]
"A" Ø OF FLANGE	6.69 [170]
"B" CAP TO Q OF CONN.	3.65 [93]
"C" FACE TO FACE	6.77 [172]
"D" OVERALL LENGTH	8.49 [216]
CONNECTIONS:	1"[DN25] Or 1-1/4[DN32]
"A" Ø OF FLANGE	8.11 [206]
"B" CAP TO Q OF CONN.	4.36 [111]
"C" FACE TO FACE	8.35 [212]
"D" OVERALL LENGTH	10.03 [255]
CONNECTIONS:	1-1/2[DN40] Or 2[DN50]
"A" Ø OF FLANGE	10.79 [274]
"B" CAP TO Q OF CONN.	6.38 [162]
"C" FACE TO FACE	11.02 [280]
"D" OVERALL LENGTH	14.25 [362]
WEIGHT NPT, BSPT & SW (LBS)	1/2 & 3/4 28[13 kg] ±4[2kg] 1" & 1-1/4 45[20 kg] ±4[2kg] 1-1/2 & 2 100[45 kg] ±4[2kg]

### OPTIONS:

CONNECTIONS	SOCKET WELD	
	NPT	
	BSPT	
BODY ORIENTATION	CST (Top)	
	CSL (Left)	
	CSR (Right)	

## DESIGN INFORMATION

MAXIMUM ALLOWABLE PRESSURE(VESSEL DESIGN)	600 psi at 650°F [41 bar at 343°C]
---	---------------------------------------



Armstrong International, Inc.  
Three Rivers Division  
Three Rivers, MI 49093  
(269) 273-1415 Fax(269) 278-6555  
Posted on Armstrong's homepage www.armstronginternational.com

Product  
F&T  
CS SERIES  
1/2 Thru 2

CD No.

1123

Rev; E sht. 1

Date

10/31/02

By; Paul G.

# DIMENSIONS & DATA CERTIFIED FOR:

Representative:

Order:

Customer:

Order:

Project:

Requirements:

By:

Date:

## LIST OF MATERIALS:

DESCRIPTION	SIZE/TORQUE MODEL NO.			MATERIAL TYPE
	CS 1/2, 3/4	CS 1, 1-1/4	CS 1-1/2, 2	
CAP & BODY	Complex Shape			ASTM A216 WCB
GASKET, BODY	Complex Shape			GRAPHITE BONDED
BOLT (8)	7/16-14 x 2-1/4 Lg	1/2-13 x 2-1/2 Lg	5/8-11 x 3-1/2 Lg	ASTM A193 GR. B7
NUT (8)	60-65 Ft. Lb.	80-95 Ft. Lb.	140-170 Ft. Lb.	ASTM A194 GR. 2H
SEAT, VALVE	9/16-20 UN		1-1/2-12 UNF	ASTM A582 T303
VALVE	50-60 Ft. Lb.		520 Ft. Lb.	ASTM A582 T440-F
RETAINER, VALVE	Complex Shape			ASTM A167 T302
PIVOT PIN	1/8 $\phi$ x 2-1/2 Lg		-	ASTM A580 T304
FLOAT	2-1/2 $\phi$	3 $\phi$	5 $\phi$	ASTM A167 T304
LEVER ASS'Y	Complex Shape			ASTM A167 T304
WT ASS'Y	9/16-20 UN 50-60 Ft. Lb.			T304 S.S.
GASKET, WT	3/4 OD x 9/16 ID			18-8 S.S.
NAME PLATE	7/8 x 3-1/2			ALUMINUM
PLUG, DRAIN NPT(3)	1/4 NPT	3/8 NPT		CARBON STEEL

## TECHNICAL INFORMATION

MODEL NO.	* BODY ORIENTATION (Top) (Left) (Right) CST CSL CSR		
	CONNECTIONS:	1/2[DN15] Or 3/4[DN20]	
"A" $\phi$ OF FLANGE	6.69 [170]		
"B" CAP TO $\phi$ OF CONN.	3.65 [93]		
"C" FACE TO FACE	6.77 [172]		
"D" OVERALL LENGTH	8.49 [216]		
CONNECTIONS:	1"[DN25] Or 1-1/4[DN32]		
"A" $\phi$ OF FLANGE	8.11 [206]		
"B" CAP TO $\phi$ OF CONN.	4.36 [111]		
"C" FACE TO FACE	8.35 [212]		
"D" OVERALL LENGTH	10.03 [255]		
CONNECTIONS:	1-1/2[DN40] Or 2[DN50]		
"A" $\phi$ OF FLANGE	10.79 [274]		
"B" CAP TO $\phi$ OF CONN.	6.38 [162]		
"C" FACE TO FACE	11.02 [280]		
"D" OVERALL LENGTH	14.25 [362]		
WEIGHT NPT, BSPT & SW (LBS)	1/2 & 3/4	28 [13 kg] $\pm$ 4[2kg]	
	1" & 1-1/4	45 [20 kg] $\pm$ 4[2kg]	
	1-1/2 & 2	100 [45 kg] $\pm$ 4[2kg]	

### OPTIONS:

CONNECTIONS	SOCKET WELD	
	NPT	
	BSPT	
BODY ORIENTATION	CST (Top)	
	CSL (Left)	
	CSR (Right)	

## DESIGN INFORMATION

MAXIMUM ALLOWABLE PRESSURE(VESSEL DESIGN)	600 psi at 650°F [41 bar at 343°C]
---	---------------------------------------

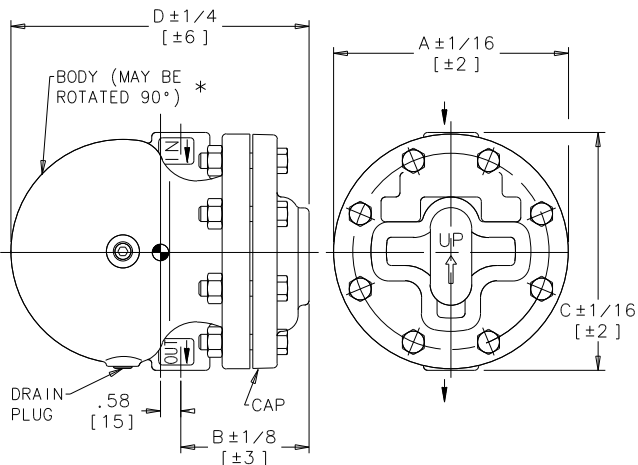

MODEL CST  
TOP INLET ORIENTATION  
1/2 & 3/4 CONN. SHOWN ABOVE

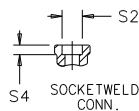

PIPE SIZE	S2	S4 MIN.
1/2[15]	.855[21.7]	3/8[9.5]
3/4[20]	1.065[27.5]	
1"[25]	1.330[33.8]	
1-1/4[32]	1.675[42.55]	1/2[12.7]
1-1/2[40]	1.915[48.64]	
2[50]	2.406[61.11]	5/8[15.9]

DIMENSIONS ARE IN INCHES[mm]  
Socket Weld Conn.  
ANSI B16.11

 Armstrong International, Inc.  
Three Rivers Division  
Three Rivers, MI 49093  
Armstrong (269) 273-1415 Fax(269) 278-6555  
Posted on Armstrong's homepage www.armstronginternational.com

Product	CD No.	Date
F&T CS SERIES (YU-TA HONG)	1123	8/9/02
Rev; A	sh. 2	By; Paul G.