

DIMENSIONS & DATA CERTIFIED FOR:

Representative:

Order:

Customer:

Order:

Project:

Requirements:

By:

Date:

LIST OF MATERIALS:

NAME OF PART	MATERIAL
CAP & BODY	ASTM A216 WCB
GASKET, BODY	GRAPHITE BONDED
BOLT (8)	ASTM A193 GR. B7
NUT (8)	ASTM A194 GR. 2H
SEAT, VALVE	ASTM A582 T303
VALVE	ASTM A564 T630/ASTM A582 T440F
RETAINER, VALVE	ASTM A167 T302
PIVOT PIN	ASTM A580 T304
FLOAT	
LEVER ASS'Y	ASTM A167 T304
WT ASS'Y	T304 S.S.
GASKET, WT	18-8 S.S.
NAME PLATE	T304 S.S.
PLUG, DRAIN (3)	CARBON STEEL

TECHNICAL INFORMATION

MODEL NO.	* ORIENTATION OF BODY (Top) (Left) (Right) CST CSL CSR
CONNECTIONS	1/2[DN15] OR 3/4[DN20]
WEIGHT NPT, BSPT & SW (LBS)	1/2 3/4 28[13 kg] ±4[2kg]

OPTIONS:

CONNECTIONS	SOCKET WELD	
	NPT	
	BSPT	
BODY ORIENTATION	CST (Top)	
	CSL (Left)	
	CSR (Right)	

DESIGN INFORMATION

MAXIMUM ALLOWABLE PRESSURE(VESSEL DESIGN)	600 psig at 650°F [41 bar at 343°C]
---	--

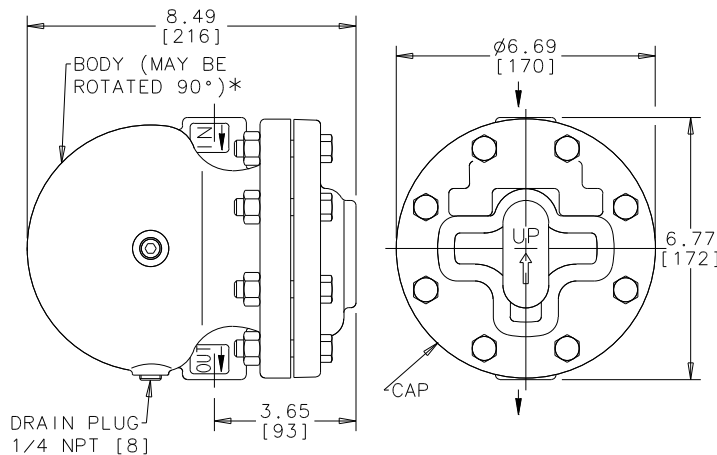

MODEL CST
TOP INLET ORIENTATION

DIMENSIONS ARE IN INCHES[mm]
Socket Weld Conn.
ANSI B16.11



Armstrong International, Inc.
Three Rivers Division
Three Rivers, MI 49093

Armstrong (269) 273-1415 Fax(269) 278-6555
Posted on Armstrong's homepage www.armstronginternational.com

Product	CD No.	Date
F&T CS SERIES 1/2 & 3/4	1120	10/31/02
	Rev; D	By; Paul G.