

# DIMENSIONS & DATA CERTIFIED FOR:

Representative:

Order:

Customer:

Order:

Project:

Requirements:

OBSOLETE per CN-20140  
6/20/07 (REF DWG CD2024)

By:

Date:

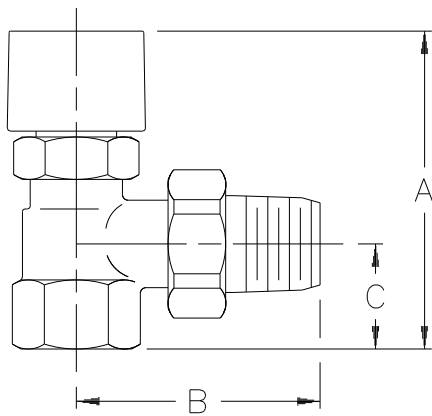

ANGLE

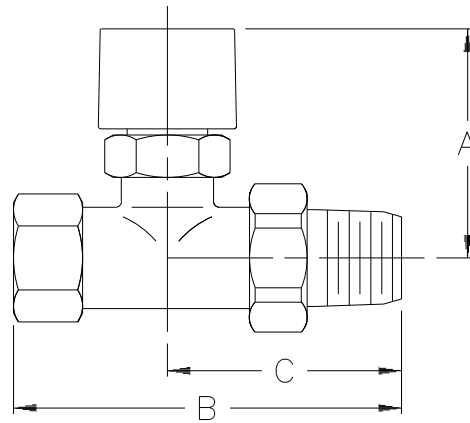

STRAIGHT

Dimensions								
Pattern	Angle				Straight			
Connection Size	1/2" [15]	3/4" [20]	1" [25]	1-1/4" [32]	1/2" [15]	3/4" [20]	1" [25]	1-1/4" [32]
"A"	3-7/16" [87mm]	3-1/2" [89mm]	3-7/8" [98mm]	4-1/4" [108mm]	2-3/4" [70mm]	2-3/4" [70mm]	2-3/4" [70mm]	2-7/8" [73mm]
"B"	2-3/8" [60mm]	2-3/4" [70mm]	3-1/8" [79mm]	3-3/8" [86mm]	3-7/8" [98mm]	4-1/4" [108mm]	5" [127mm]	5-7/8" [149mm]
"C"	1" [25mm]	1-1/8" [29mm]	1-3/8" [35mm]	1-1/2" [38mm]	2-1/2" [63mm]	2-9/16" [65mm]	3-3/8" [86mm]	3-1/2" [89mm]
Weight	3/4 lbs [0.3 kgs]	1 lbs [0.5 kgs]	1-1/2 lbs [0.7 kgs]	1-3/4 lbs [0.8 kgs]	3/4 lbs [0.3 kgs]	1 lbs [0.5 kgs]	1-3/4 lbs [0.8 kgs]	2 lbs [0.9 kgs]

NOTE:

1) Reversed Angle style and solder connections available. Consult factory

Specifications		
Application	Maximum Pressure	Maximum Temperature
Steam	15 psig [1 bar]	250 °F [121 °C]
Water		

Materials	
Body	Brass (Nickel Plated)
Union Nipple	Brass (Nickel Plated)
*Disc	EPDM

\*S\* Insert available (Chrome Nickel Steel)

Armstrong Pressure/Temperature Group  
221 Armstrong Blvd.,  
Three Rivers, MI. 49093  
**Armstrong** (269) 279-3600 Fax(269) 273-8656  
Posted on [www.armstronginternational.com](http://www.armstronginternational.com)

Product	CDY No.	Date
MV-3 RADIATOR VALVE	1044	3/06/98
		Rev. A