

# DIMENSIONS & DATA CERTIFIED FOR:

Representative:

Order:

Customer:

Order:

Project:

Requirements:

By:

Date:

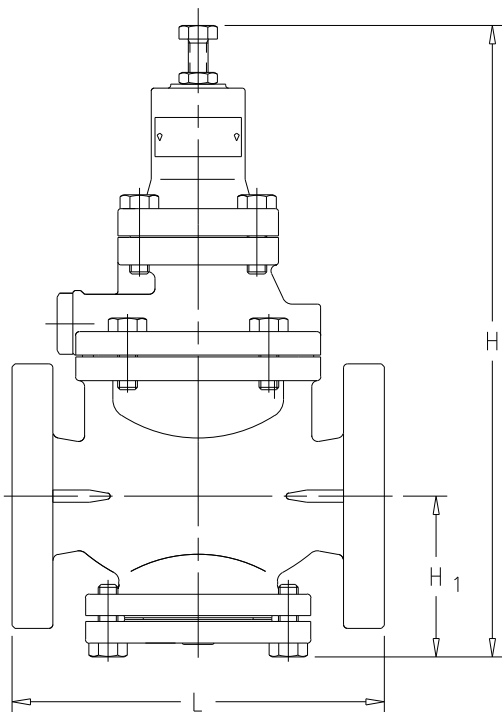

## Dimensions & Weights

SIZE	L (300 lb. Flange)	H	H <sub>1</sub>	Cv [Kv]	Weight lbs [kgs]
1/2 [15]	5.91 [150]	11.22 [285]	2.52 [64]	1.0 [0.9]	17.6 [8.0]
3/4 [20]	6.10 [155]	11.22 [285]	2.52 [64]	2.3 [2.0]	18.7 [8.5]
1 [25]	6.30 [160]	11.81 [300]	2.64 [67]	4.0 [3.5]	22.0 [10.0]
1-1/4 [32]	7.48 [190]	12.72 [323]	3.23 [82]	6.5 [5.6]	30.9 [14.0]
1-1/2 [40]	7.48 [192]	12.72 [323]	3.23 [82]	9.0 [7.8]	32.0 [14.5]
2 [50]	8.66 [225]	13.66 [347]	3.66 [93]	16.0 [13.9]	44.1 [20.0]
2-1/2 [65]	9.66 [252]	14.06 [357]	3.94 [100]	25.0 [21.6]	66.1 [30.0]
3 [80]	11.42 [303]	15.91 [404]	4.80 [122]	36.0 [31.2]	77.2 [35.0]
4 [100]	12.99 [346]	17.72 [450]	5.67 [144]	64.0 [55.5]	115.7 [52.5]

Dimensions Are In Inches [mm]

### LIST OF MATERIALS

BODY	DUCTILE IRON ASTM A536
MAIN VALVE	STAINLESS STEEL AISI 420
MAIN VALVE SEAT	STAINLESS STEEL AISI 420
PILOT VALVE	STAINLESS STEEL AISI 420
PILOT VALVE SEAT	STAINLESS STEEL AISI 420
DIAPHRAGM	STAINLESS STEEL AISI 301
PISTON	STAINLESS STEEL AISI 304
CYLINDER	STAINLESS STEEL AISI 304
BOLTING	CARBON STEEL

### SPECIFICATIONS

APPLICATION	STEAM
INLET PRESSURE	15-300 psig [1-21 bar]
REDUCED PRESSURE	7-131 psig [0.5-9 bar]
	131-203 psig [9-14 bar]
MAX. TEMPERATURE	450°F [232°C]
MIN. DIFFERENTIAL	7 psig [0.5 bar]

NOTES;

1. MAXIMUM REDUCTION RATIO 20-1



**ARMSTRONG PRESSURE/TEMPERATURE GROUP**  
 221 Armstrong Boulevard  
 Three Rivers, MI 49093  
 Phone No. 1-269-279-3600 Fax 1-269-273-8656  
 Posted on Armstrong's homepage [www.armstrong-intl.com](http://www.armstrong-intl.com)

GP-1000H

Date

9/15/04

Rev.

A

Drawing No.

CDY 1103