

TC-300 Series Thermostatic Wafer Steam Trap

Carbon Steel

For Pressures to 250 psig (17 bar)...Cold Water Start-Up Capacities to 1,000 lb/hr (453 kg/hr)



Steam Trapping and
Steam Tracing Equipment

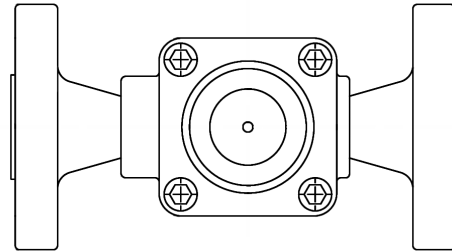
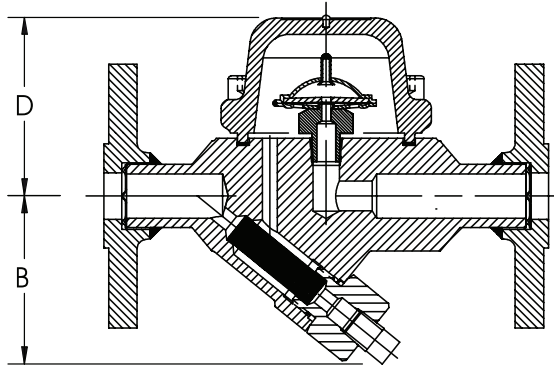

Description

The TC-300 is sized precisely to handle the extremely low condensate load found in most instrument steam tracer lines. The TC-300 traps are designed to last longer than other oversized, all-purpose thermostatic and thermodynamic steam traps.

This steam trap adjusts automatically to flow rates, including large start-up loads, at all pressures within its range.

How to Order

Specify: Model Number, Size and type of pipe connection. When flanges are required, specify type of flange in detail.

TC-300 Series Thermostatic Wafer Steam Trap Capacity							
Differential Pressure*		Cold Water Start-Up 70°F (21°C)		Hot Water Start-Up 212°F (100°C)		Operating Condensate 50°F (28°C) Below Saturation	
psi	bar	lb/hr	kg/hr	lb/hr	kg/hr	**lb/hr	**kg/hr
5	0.35	120	54	100	45	10	4.5
10	0.70	150	68	170	77	13	5.9
20	1.4	320	145	250	113	18	8.2
30	2	390	177	300	136	20	9.1
40	3	420	191	350	159	24	10.9
50	3.5	490	222	400	181	26	11.8
75	5	570	259	480	218	30	13.6
100	7	650	295	580	263	35	15.9
150	10.5	700	318	700	318	40	18.1
200	14	900	408	800	363	46	20.9
250	17	1,000	454	950	431	50	22.7

* Capacities based on differential pressure with no back pressure.

** Capacities will vary with the degree of subcooling. When greater capacities are required, the trap will automatically adjust to the load, up to the maximum (cold water) capacity shown, by increasing the amount of subcooling.

TC-300 Trap		
Pipe Connections	in	mm
	1/2, 3/4, 1	15 – 20 – 25
"B" Height (Screwed & SW)	4-19/32	117
"A" Height (flanged PN40*)	4-19/32	117
"C" Face-to-Face (Screwed & SW)	3-1/2 – 3-1/2 – N/A	90 – 90 – N/A
"CC" Face-to-Face (Flanged PN40*)	5-29/32 – 5-29/32 – 6-19/64	150 – 150 – 160
"D" CL to Top	2-3/8	60
Weight in kg (Screwed & SW)	4-1/4	1,9
Weight in kg (Flanged PN40)	9-1/2 – 9-1/2 – 10	4,3 – 4,5 – 4,7

TC-300 Traps	
Model	TC-300
Connections	Screwed BSPT and NPT Socketwelded Flanged DIN and ANSI
Material	
Cap and Body	ASTM-A-105
Capsule	All Stainless Steel – 304
Maximum Operating Conditions	
Maximum allowable pressure (vessel design)†	465 psi @ 662°F (32 bar @ 350 °C)
Maximum operating pressure	250 psi @ 400°F (17 bar @ 207 °C)

† May be derated depending on flange rating and type.