

DIMENSIONS & DATA CERTIFIED FOR:

Representative:

Order:

Customer:

Order:

Project:

Requirements:

By:

Date:

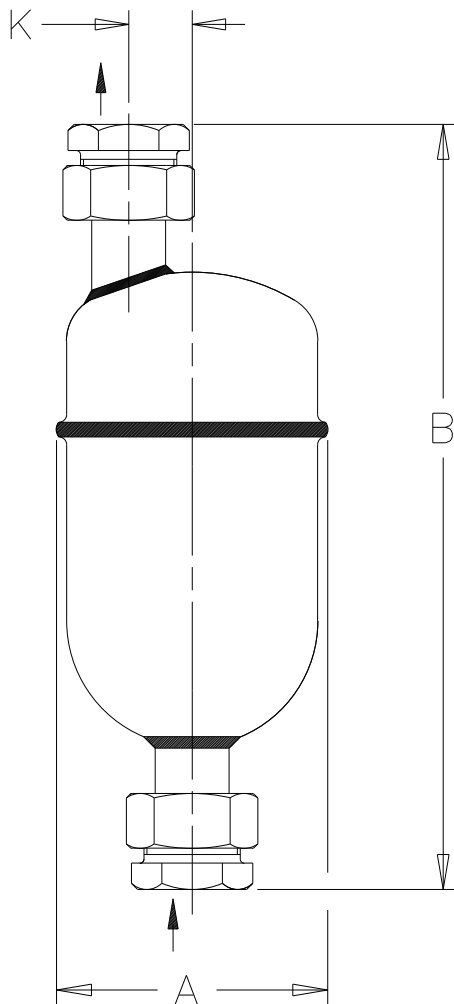

Dimensions Are In Inches [mm]

LIST OF MATERIALS:

NAME OF PART	MATERIAL
CAP & BODY	ASTM A240 T304L SS
VALVE SEAT/VALVE	17-4 PH
BUCKET	ASTM A167 T304 SS
LEVER ASS'Y	ASTM A167 T302 SS
LEVER	CARPENTER 20Cb-3 SS
GUIDE PLATE ASS'Y	ASTM A240 T304 SS
MECHANISM SUPPORT	ASTM A479 T304 SS
UNION NUT	ASTM A582 T303 SS
GASKET	SPIRAL WOUND T304 SS
UNION CONN.	ASTM A108 GR.1018

TECHNICAL INFORMATION

MODEL NO.	U-1022
CONNECTION NPT, BSPT & SW	1/2 [DN15] 3/4 [DN20]
"A" (BODY ϕ)	3-7/8 [98]
"B" (HEIGHT)	10-15/16 [278]
"K" (ϕ To ϕ OF OUTLET)	29/32 (5/16 Orifice)
	23/32 (1/4, 3/16, 5/32, 1/8, 7/64 & #38 Orifice)
WEIGHT	3-1/2 lbs [1.6 kgs]

DESIGN INFORMATION

MAXIMUM ALLOWABLE PRESSURE (VESSEL DESIGN)	450 psig at 500°F [31 bar at 260°C]
MAXIMUM OPERATING PRESSURE	450 psig [31 bar]

Armstrong International, Inc.
 Three Rivers Division
 Three Rivers, MI 49093
 (269) 273-1415 Fax(269) 278-6555
 Posted on Armstrong's homepage www.armstronginternational.com

Product	CD No.	Date
TRAP U-1022 W/ THD./SW CONN.	1257	6/14/02
Rev; A	SHT. 1	By; Paul G.

DIMENSIONS & DATA CERTIFIED FOR:

Representative:

Order:

Customer:

Order:

Project:

Requirements:

By:

Date:

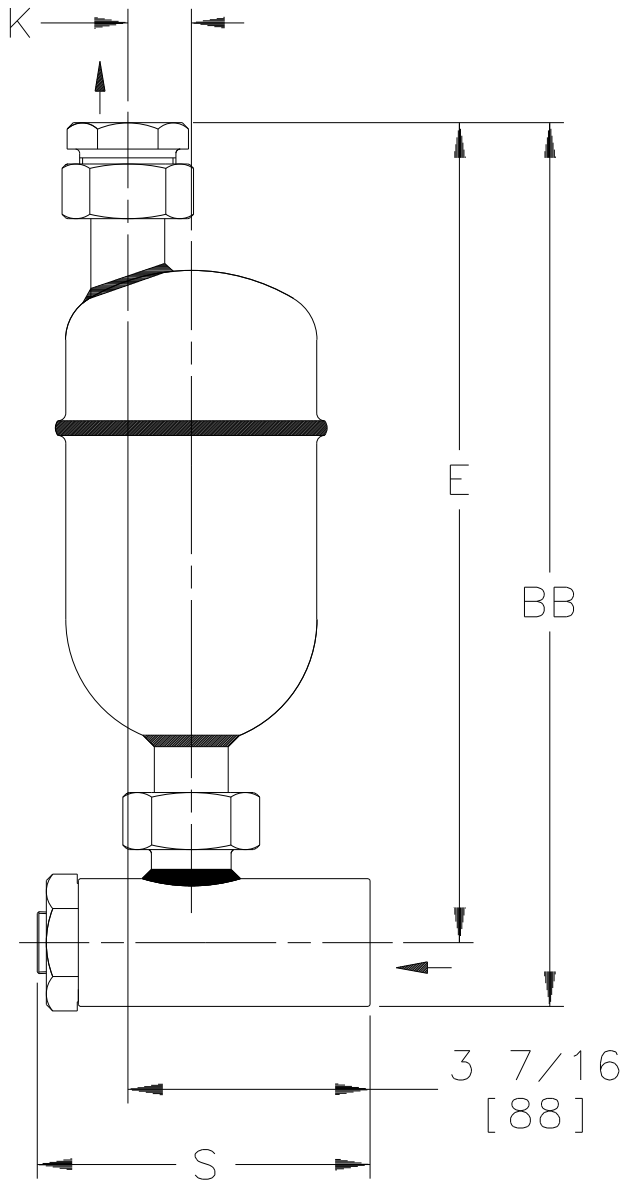

Dimensions Are In Inches [mm]

LIST OF MATERIALS:

NAME OF PART	MATERIAL
CAP & BODY	ASTM A240 T304L SS
VALVE SEAT/VALVE	17-4 PH
BUCKET	ASTM A167 T304 SS
LEVER ASS'Y	ASTM A167 T302 SS
LEVER	CARPENTER 20Cb-3 SS
GUIDE PLATE ASS'Y	ASTM A240 T304 SS
MECHANISM SUPPORT	ASTM A479 T304 SS
UNION NUT	ASTM A582 T303 SS
GASKET	SPIRAL WOUND T304 SS
UNION CONN.	ASTM A108 GR.1018
STRAINER BODY	
SCREEN	.045 PERF. T304 SS

TECHNICAL INFORMATION

MODEL NO.	U-1022 W/ STRAINER
CONNECTION NPT, BSPT & SW	1/2 [DN15] 3/4 [DN20]
"S" (STR. BODY LENGTH)	4-3/4 [121]
"BB" (HEIGHT)	12-9/16 [319]
"K" (¢ To ¢ OF OUTLET)	29/32 (5/16 Orifice)
	23/32 (1/4, 3/16, 5/32, 1/8, 7/64 & #38 Orifice)
"E" (¢ INLET TO OUTLET)	11-5/8 [295]
WEIGHT	5-1/4 lbs [2.4 kgs]

DESIGN INFORMATION

MAXIMUM ALLOWABLE PRESSURE (VESSEL DESIGN)	450 psig at 500°F [31 bar at 260°C]
MAXIMUM OPERATING PRESSURE	450 psig [31 bar]